

DB-6 SERIES

額定電流、電壓 RATING

5A 250VAC T105 UL cUL
2.5A 250VAC ENEC VDE CCC KC

規格標準 STANDARD

IEC 60320 C6

絕緣電阻 INSULATION RESISTANCE

100MΩ 500V DC/1 MIN

介電強度 DIELECTRIC INTENSITY

2500VAC/5S

材質防火 MATERIAL

94V-2~V-0



東莞市高迪電子有限公司
DONG GUAN GAO DI ELECTRONICS CO., LTD

TOLERANCE UNLESS OTHERWISE STATED:

Up to 5 ±0.2
Above 5 ~ 15 ±0.3
Above 15 ~ 30 ±0.4
Above 30 ~ 50 ±0.5
Angle ±0.3°

3RD. ANGEL'S

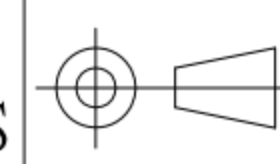

UNITS

MM

DRAWN BY: DATE
Ming Ming Zou 10/31/13

CHECKED BY: DATE
Ning Ning Su 10/31/13

APPROVED BY: DATE
Jia Xiang 10/31/13

MAT'L

FINISH

SCALE

SHEET NO.

TITLE SWITCH

MODLE AC POWER SOCKET

DWG NO. **GD-DB-5DS12**

PART NO.

1 of 1

SIZE
A4
VER
R